

Prefabricated Data Center

FusionModule1000C Prefabricated Modular Data Center

Introduction

Traditional data centers suffer from long construction periods, high energy consumption and high initial investment. To help resolve these issues, HUAWEI has launched the FusionModule1000C outdoor data center solution, which has a highly integrated power system, environmental monitoring, cooling systems, racks, cabling, fire control, security and other infrastructure facilities.

This solution complies with the diverse business needs of customers today.

Application Scenarios

- IT load $\leq 270\text{kW}$
- Fast deployment, staged deployment scenario

Features & Value

Simple

- Prefabricated and pre-tested
- Modular structure realizes fast & on-demand deployment
- Intelligent management makes unattended operation

Efficient

- High energy efficiency, PUE down to 1.2
- High density and saving 80% footprint

Reliable

- Component/device/system triple reliable design
- IP55 external protection level and 9 degree anti-seismic intensity performance
- Operable from -40°C to $+55^{\circ}\text{C}$

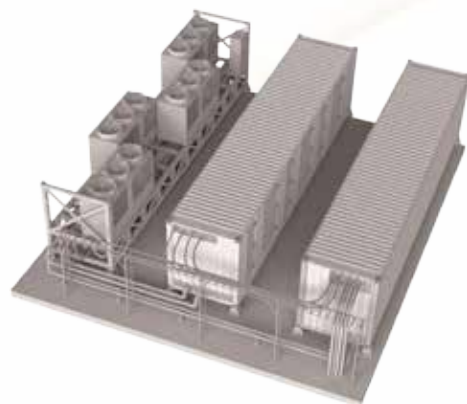

FusionModule1000C



FusionModule1000C

Specifications

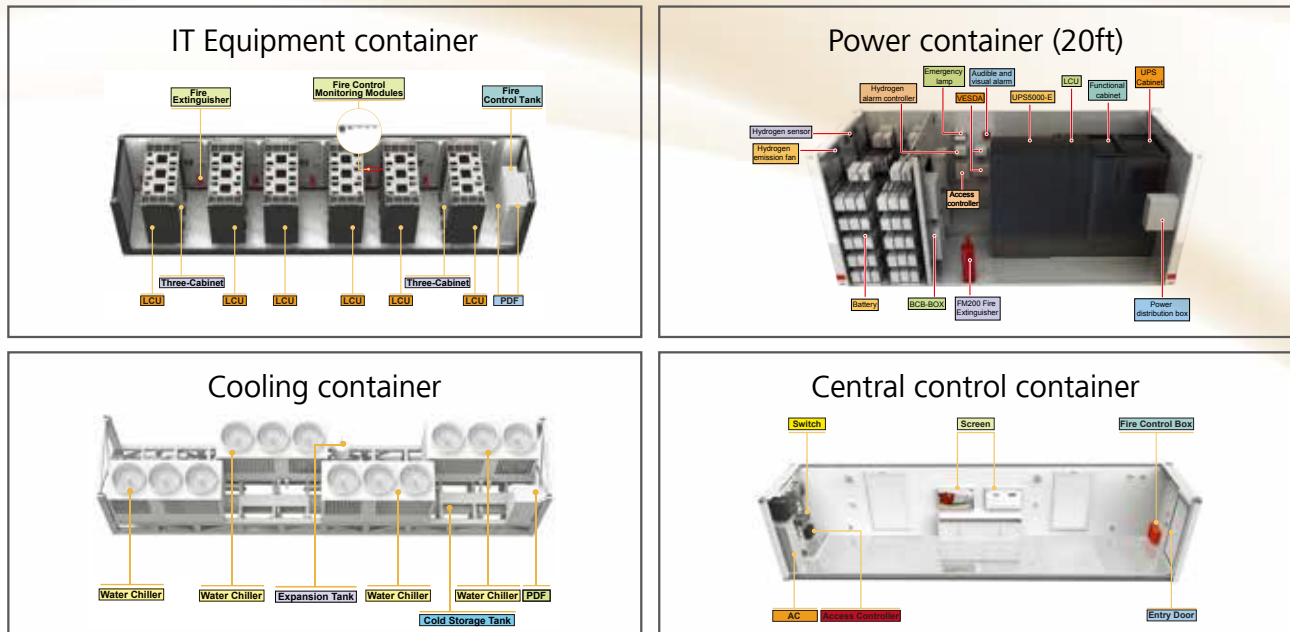

Component	Features	
Power	Input power	380/400/415Vac, 50/60Hz, 3Ph+N+PE
	Power density per rack	3kW~15kW
	UPS capacity	40kVA~320kVA
	UPS redundancy	2N or N+X
	Battery backup time	10mins
Cooling- Chilled water	Technology	Outdoor unit: Four 100kW chillers for 3+1 backup Indoor unit: twelve 30kW units for 9+3 backup
	Containment	Hot and cold aisle isolation
	Total cooling capacity	300kW
	Indoor unit capacity	30kW
	Indoor unit size (H x W x D)	2100mm x 300mm x 1000mm
	Refrigerant	R410A or R134a
	Fan type	EC Fans
	Compressor	Scroll compressor
Design operation Parameters	Humidity control	20%~80%
	Temperature	-40°C ~ +55°C*
Size	Relative humidity	10%~100%
	IT container (L x W x H)	12192mm x 2438mm x 2896mm
	Cooling container (L x W x H)	12192mm x 2438mm x 2896mm
	Power container (L x W x H)	6058mm x 2438mm x 2896mm
	Rack	45U/rack, 18 IT racks

* +45°C ~ +55°C tropical conditions should use high temperature air conditioner, -40°C ~ -15°C conditions should use low temperature air conditioner, some parameters will change.

General Disclaimer

The information in this document may contain predictive statements including, without limitation, statements regarding the future financial and operating results, future product portfolio, new technology, etc. There are a number of factors that could cause actual results and developments to differ materially from those expressed or implied in the predictive statements. Therefore, such information is provided for reference purpose only and constitutes neither an offer nor an acceptance. Huawei may change the information at any time without notice.

HUAWEI TECHNOLOGIES CO., LTD.

Huawei Industrial Base
Bantian Longgang
Shenzhen 518129, P.R. China
Tel: +86-755-28780808